

100 YEAR
FLOODPLAIN
BOUNDARY

ESA
BOUNDARY

129.80

132.09

129.80

132.09

West Travis Street
(55.6' ROW)

TREE INVENTORY		
UNDERSIZED	SIGNIFICANT	HERITAGE
10" RETAMA (DEAD - Tree Inspector Verified) 8" CHINA BERRY (Invasive) 6" CHINA BERRY (Invasive) 8" CHINA BERRY (Invasive) 15" PECAN (DEAD - Tree Inspector Verified) 8" HACKBERRY	12" HACKBERRY 10" HACKBERRY 10" RETAMA 9" ANAQUA 12" HUISACHE 10" MESQUITE 16" HUISACHE	N/A

TREE PRESERVATION	
PRESERVED	REMOVAL
12" HACKBERRY 10" RETAMA 9" ANAQUA 8" HACKBERRY	10" RETAMA (DEAD - Tree Inspector Verified) 8" CHINA BERRY (Invasive) 6" CHINA BERRY (Invasive) 8" CHINA BERRY (Invasive) 15" PECAN (DEAD - Tree Inspector Verified) 10" HACKBERRY 12" HUISACHE 10" MESQUITE 16" HUISACHE

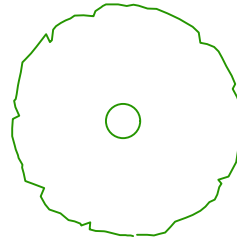

EXISTING TREE

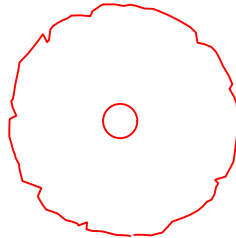

EXISTING TREE TO BE REMOVED TREE

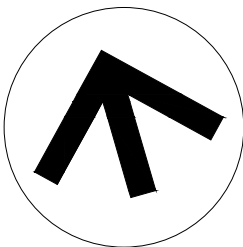

NORTH

SIGNIFICANT

TOTAL SIGNIFICANT INCHES = 79"
40% (REQ. PRESERVATION) x 79" = 31.6" (REQ.)
39" (SIGN. PRESERVED) / 79" = 49.36%

HERITAGE

TOTAL HERITAGE INCHES = 0"
100% (REQ. PRESERVATION) x 0" = 0"
HERITAGE PRESERVED = 0" (100%)

ESA BUFFER

TOTAL ESA INCHES = 24"
80% (REQ. PRESERVATION) x 24" = 19.2" (REQ.)
8" (PRESERVED) / 24 = 33.33%
MITIGATING 16" (8 - 2" TREES)

1619 W Travis St

Project Name

Tree Preservation Plans

Sheet Name

11-07-22

Date

3/23" = 1'-0"

Scale

T1

Sheet

100 YEAR
FLOODPLAIN
BOUNDARY

ESA
BOUNDARY

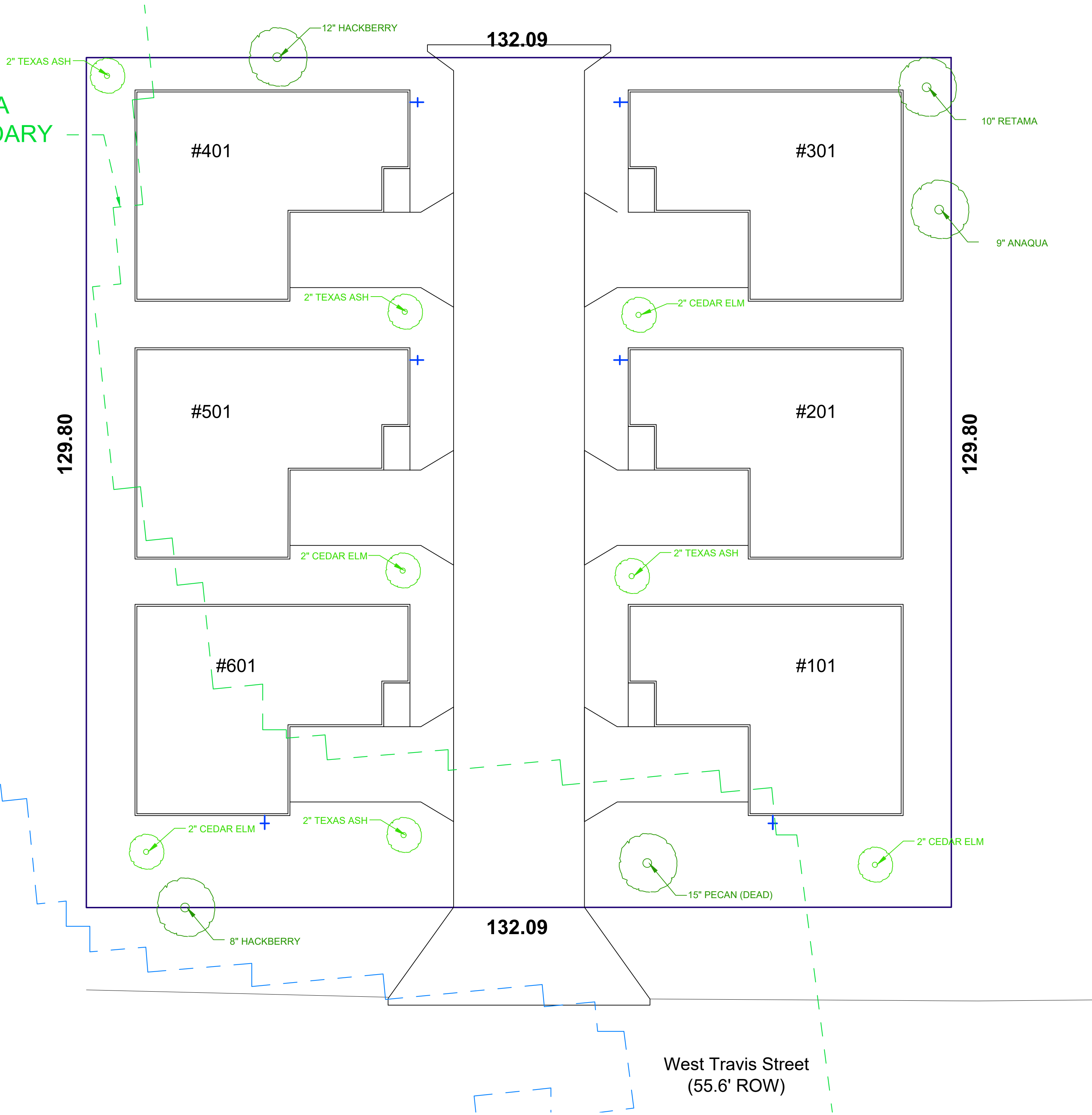

TREE CANOPY CALCULATION

TOTAL PROJECT AREA: 17,162 SF
17,162 X 15% (CRAG) = 2,574.3 SF REQ.
2,900 SF (EXISTING SHADE AREA)

ADDITIONAL CANOPY NEW TREES: 787.5 SF x 8 =
6,300 SF

EXISTING TREE SHADE AREA	
TREE	SHADE
12" HACKBERRY	875
10" RETAMA	275
9" ANAQUA	875
8" HACKBERRY	875
TOTAL	2,900

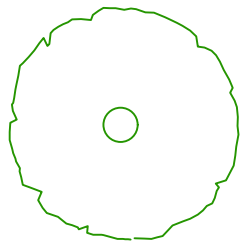

EXISTING TREE

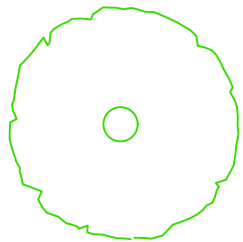

NEW TREE

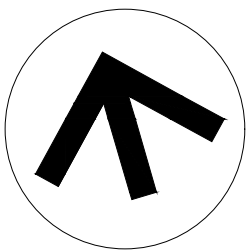

NORTH

***ALL TREES WILL BE WITHIN 100'
OF A HOSE BIB**

1619 W Travis St
Project Name

Tree Mitigation & Tree Canopy Planting Plan
Sheet Name

11-07-22
Date

3/23" = 1'-0"
Scale

T2
Sheet